

**⚠ Before you begin, determine your channel letter module mounting method. ⚠**  
**READ THESE INSTRUCTIONS COMPLETELY AND CAREFULLY.**

**PREPARE ELECTRICAL WIRING**

- Acceptable for use in dry, damp and wet locations.
- Follow all National Electric Codes (NEC) and local codes.
- This product is intended to be installed and serviced by a qualified, licensed electrician.
- Ensure applicable wire is installed between driver, fixture, and any controls in between.
- When choosing wire, factor in voltage drop, amperage rating, and type (in-wall rated, wet location rated, etc.).
- Inadequate wire installation could overheat wires, and cause a fire.
- Do not install if product has any visible damage.
- Do not modify or disassemble this product beyond instructions or the warranty will be void.

**RISK OF ELECTRICAL SHOCK**

- Turn power off before inspection, installation or removal.
- Properly ground power supply.

**RISK OF FIRE**

- Use only UL approved wire for input/output connections.
- Minimum wire size 18 AWG
- Follow all NEC and local codes.

**SHOCK HAZARD. ⚡**

- May result in serious injury or death.
- Turn off power at the circuit breaker before installing

**TOOLS REQUIRED:**



Tape Measure



Electric Drill



Wire Cutter



Wire Nut



Electrical Tape



Silicone Gun

**TOOLS REQUIRED:**

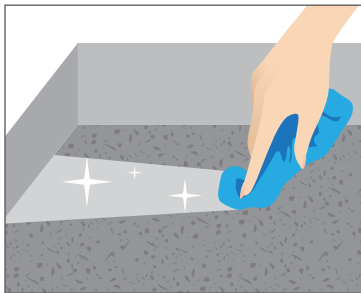

Cleaning without leaving dust.

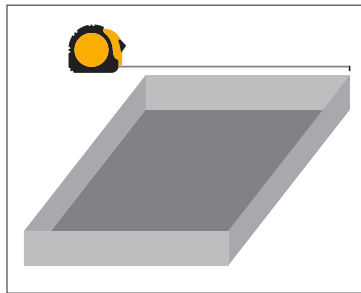

Measure and calculate for how many need LED module put in.

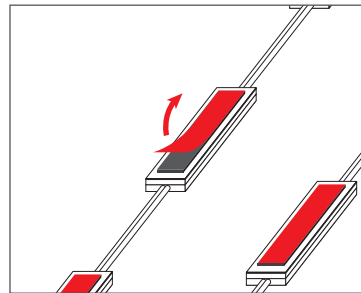

Remove tape cover.

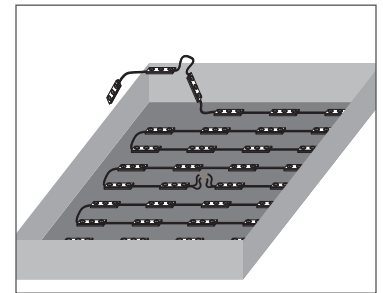

Stick LED modules into place.

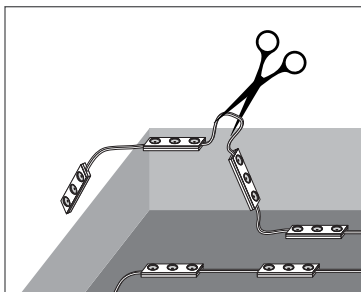

Cut the wire for connect DC power.

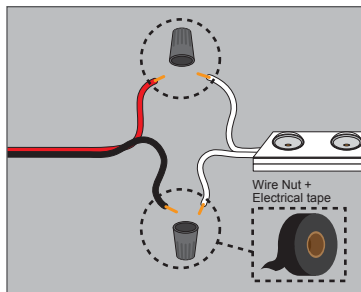

Connect DC power with wire nuts and electrical tape.

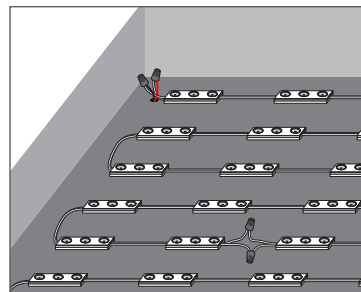

Last check before silicone.

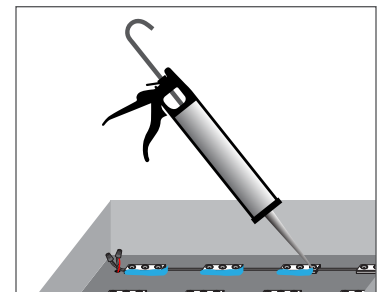

Siliconing.